

SPECIFICATIONS:

CONTACT RATING: Refer to "Contact Material Options" for more info.
 ELECTRICAL LIFE: Min. 50,000 make-and-break cycles at full load.
 CONTACT RESISTANCE: 10mΩ max. initial @2-4VDC
 100mA for both silver and gold plated contacts.
 INSULATION RESISTANCE: 1,000MΩ min.
 DIELECTRIC STRENGTH: 1,500V RMS @ sea level.
 OPERATING TEMPERATURE: -30°C to +85°C

MATERIALS:

CASE: Diallyl phthalate(DAP)(UL 94V-0).
 TOGGLE HANDLE: Brass, black finish with o-ring sealed.
 BUSHING: Brass, black finish with o-ring sealed
 EXTERNAL SHELL: LCP.
 TERMINAL SEAL: Epoxy.

If your preferred product configuration is not shown, please contact our sales representative for custom design.

HOW TO ORDER SYSTEM

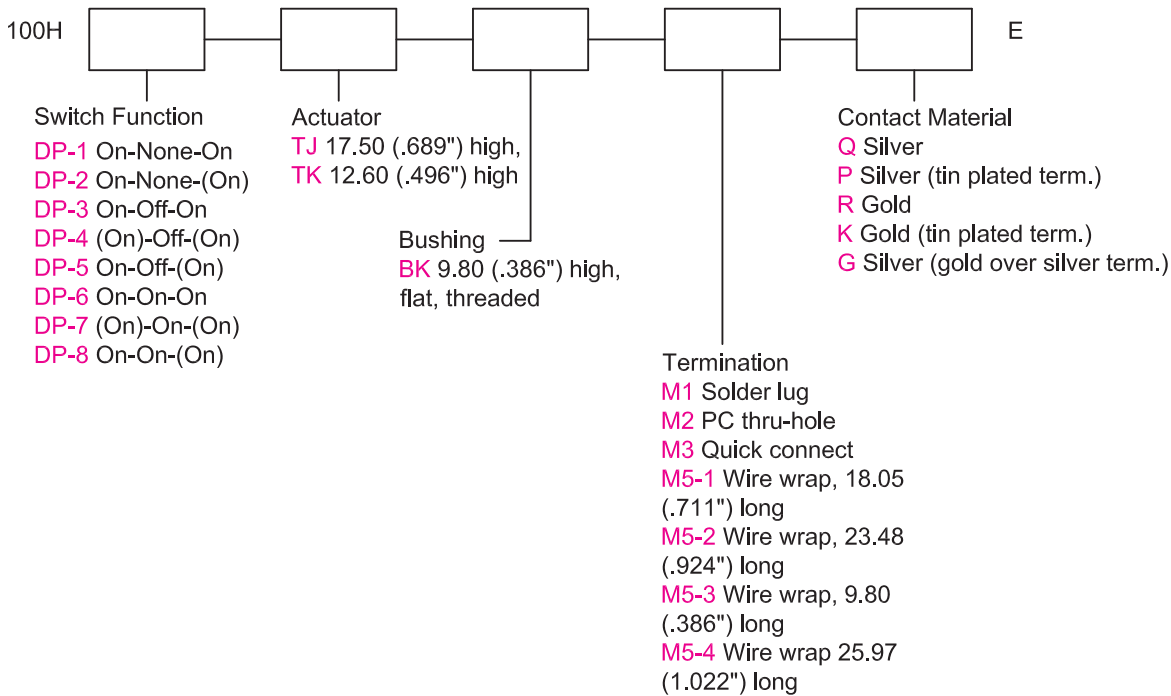

Series 100H

High Performance Sealed Toggle Switches

DPDT



Model No.	Switching Position		
DP-1	ON	NONE	ON
DP-2	ON	NONE	(ON)
DP-3	ON	OFF	ON
DP-4	(ON)	OFF	(ON)
DP-5	ON	OFF	(ON)
Term. Comm.	2-3,5-6	OPEN	2-1,5-4

Model No.	Switching Position		
DP-6	ON	ON	ON
DP-7	(ON)	ON	(ON)
DP-8	ON	ON	(ON)
Term. Comm.	2-3,5-6	2-3,5-4	2-1,5-4

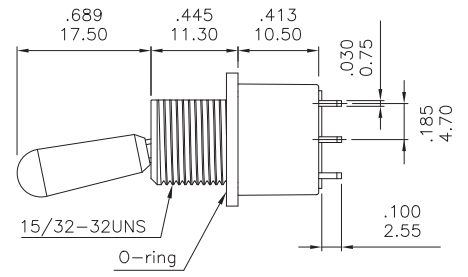
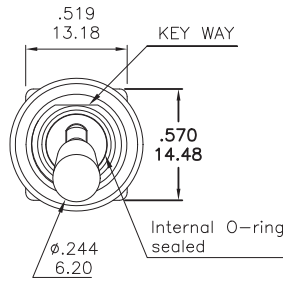

Schematic

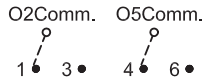

WIRING FOR ON-ON-ON (3-WAY) FUNCTION

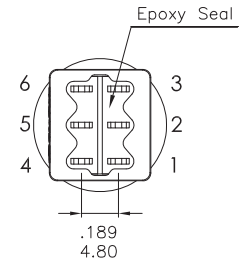
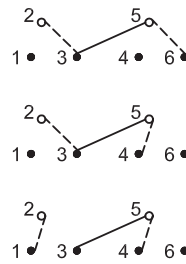
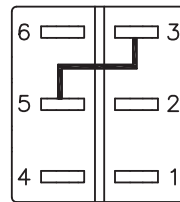

ACTUATOR OPTIONS

TJ

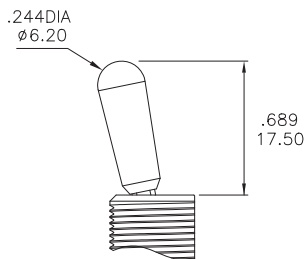

TK

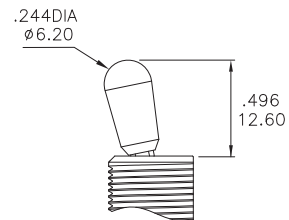

BUSHING OPTION

BK

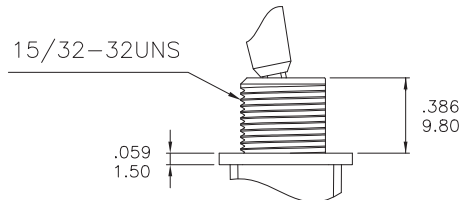

PANEL MOUNTING

15/32 INCH BUSHING

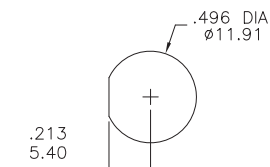

()=MOMENTARY

TERMINATION OPTIONS

M1 STD. SOLDER LUG

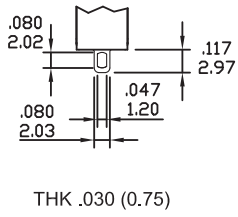

M2 PC THRU-HOLE

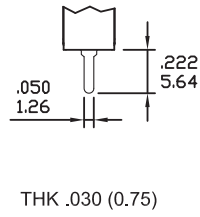

M3 QUICK CONNECT

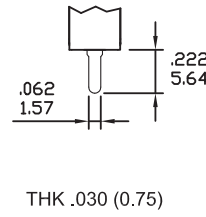

M5 WIRE WRAP

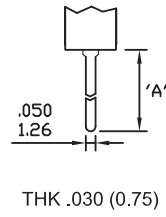

OPTION CODE	DIM.'A'
M5-1	.711(18.05)
M5-2	.924(23.48)
M5-3	.386(9.80)
M5-4	1.022(25.97)

NUT

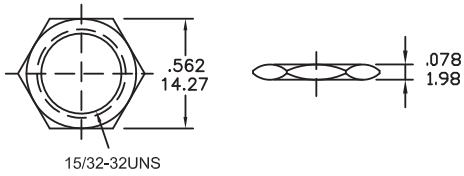

LOCK WASHER

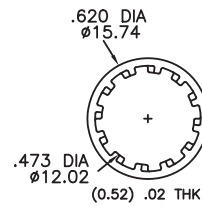

CONTACT MATERIAL OPTIONS

Coding	Contact Material	Terminal Plating	Rating	Agency Approvals
Q	Silver ¹	Silver plated ¹	5Amps @ 125VAC or 28VDC 2Amps @ 250VAC	
P		Tin plated ⁵ ⁷		
R	Gold ²	Gold plated ⁴	0.4VA max @ 20V max (AC or DC)	
K		Tin plated ⁵ ⁶		
G	Silver ¹	Gold over silver ³	5Amps @ 125VAC or 28VDC 2Amps @ 250VAC	

1. Movable Contact / Terminals: Copper alloy, silver plated.
2. Movable Contact: Copper alloy with gold plated over nickel plated.
3. Terminals: Silver plated with outer layer in gold plating.
4. Terminals: Copper alloy, with gold plated over nickel plated.
5. Outer Terminals: Copper alloy with pure tin plated.
6. Terminal Contact: Gold plated over nickel plated.
7. Terminal Contact: Palladium nickel alloy (or Silver) plated.

* P, K not available with M1 and M3 terminals

* 6Amps (Movable Contact: coin silver, silver plated) available to model ON-NONE-ON without UL approval