

SPECIFICATIONS:

CONTACT RATING: Refer to "Contact Material Options" for more info.
 ELECTRICAL LIFE: 50,000 make-and-break cycles at full load.
 CONTACT RESISTANCE: 10mΩ max. initial @2-4VDC
 100mA for both silver and gold plated contacts.
 INSULATION RESISTANCE: 1,000MΩ Min.
 DIELECTRIC STRENGTH: 1,500 V RMS @ sea level.
 OPERATING TEMPERATURE: -30° C~+85° C.

MATERIALS:

CASE & BUSHING: PA9T or FR52, flame retardant, heat stabilized (UL94V-0).
 ACTUATOR: Brass chrome plated, internal o-ring sealed (100A).
 ACTUATOR: Brass chrome plated (100C).
 SWITCH SUPPORT: Brass, tin plated.
 TERMINAL SEAL: Epoxy.

If your preferred product configuration is not shown, please contact our sales representative for custom design.

HOW TO ORDER SYSTEM

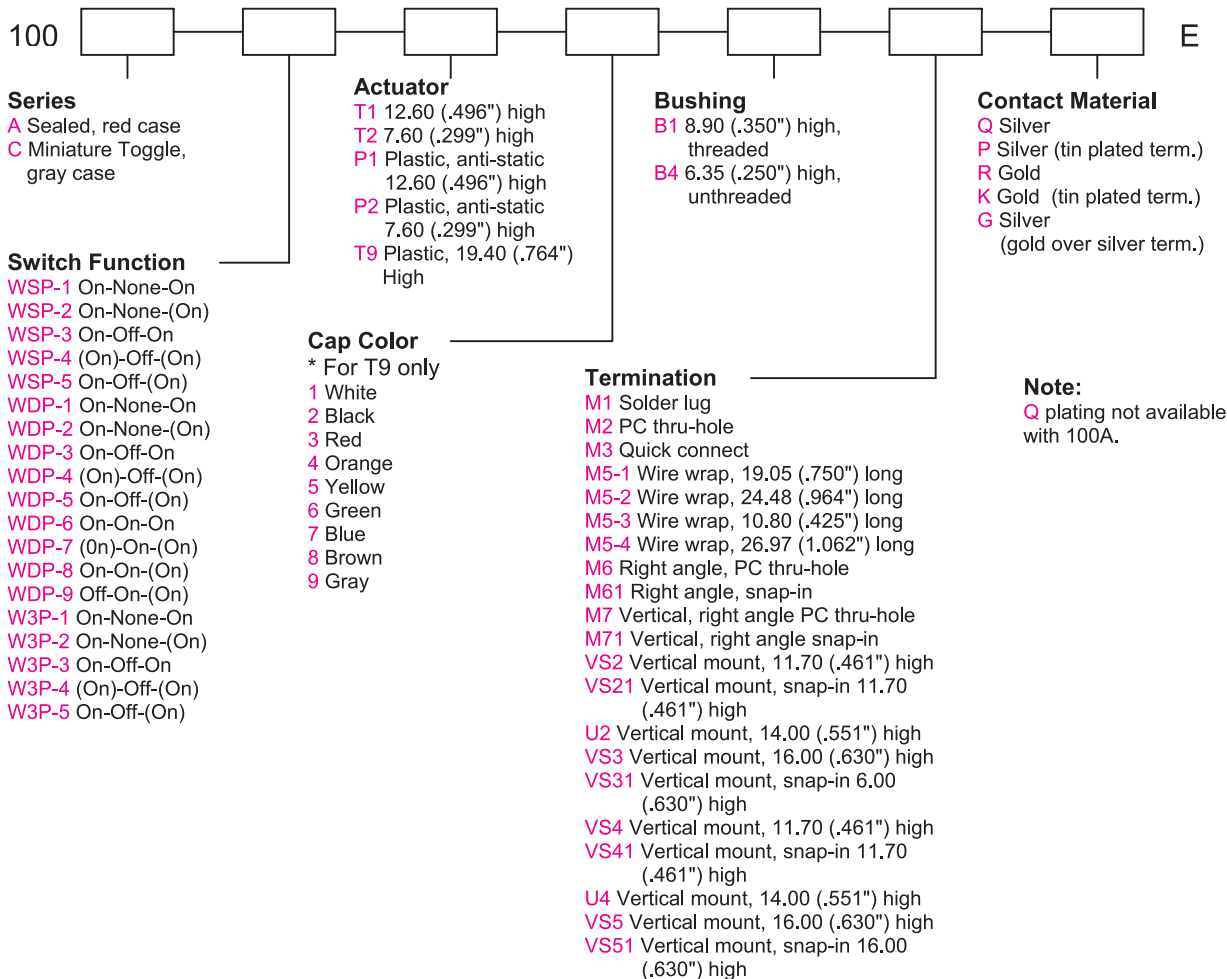

Series 100A/C

(Sealed) Miniature Toggle Switches

SPDT



Model No.	Switching Position		
WSP-1	ON	NONE	ON
WSP-2	ON	NONE	(ON)
WSP-3	ON	OFF	ON
WSP-4	(ON)	OFF	(ON)
WSP-5	ON	OFF	(ON)
Term. Comm.	2-3	OPEN	2-1

Schematic

O2Comm.

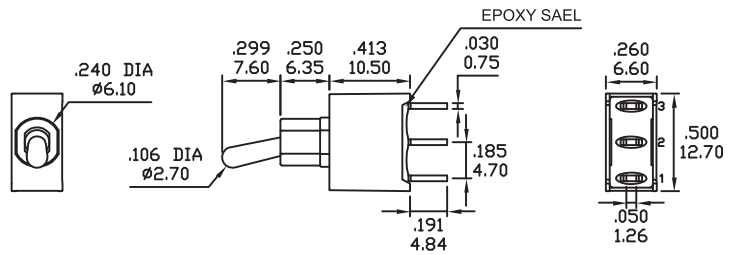

DPDT



Model No.	Switching Position		
WDP-1	ON	NONE	ON
WDP-2	ON	NONE	(ON)
WDP-3	ON	OFF	ON
WDP-4	(ON)	OFF	(ON)
WDP-5	ON	OFF	(ON)
Term. Comm.	2-3,5-6	OPEN	2-1,5-4

Schematic

O2Comm.

O5Comm.

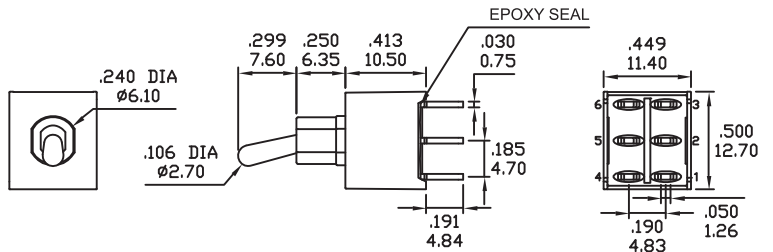

WIRING FOR ON-ON-ON (3-WAY) FUNCTION

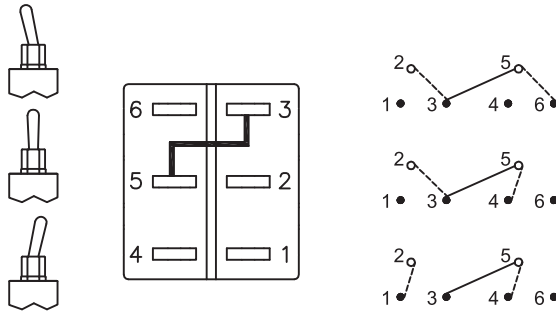

3PDT



Model No.	Switching Position		
W3P-1	ON	NONE	ON
W3P-2	ON	NONE	(ON)
W3P-3	ON	OFF	ON
W3P-4	(ON)	OFF	(ON)
W3P-5	ON	OFF	(ON)
Term. Comm.	2-3,5-6 8-9	OPEN	2-1,5-4 8-7

Schematic

O2Comm.

O5Comm.

O8Comm.

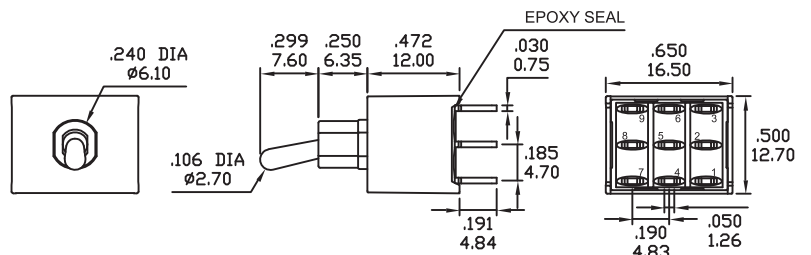

ACTUATOR OPTIONS

T1

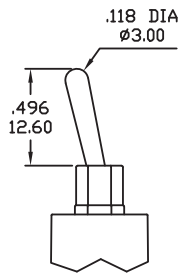

T2

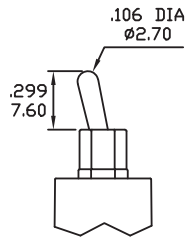

T9 WITH PLASTIC CAP

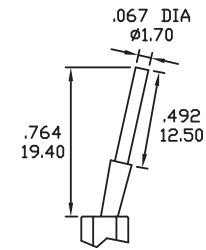

NO.	COLOR
1	White
2	Black(std.)
3	Red
4	Orange
5	Yellow
6	Green
7	Blue
8	Brown
9	Gray

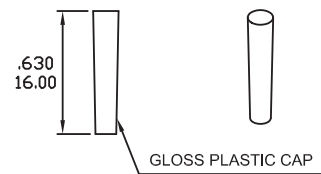

P1 PLASTIC TOGGLE

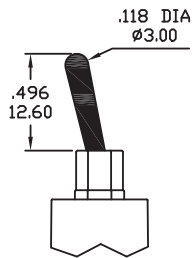

P2 PLASTIC TOGGLE

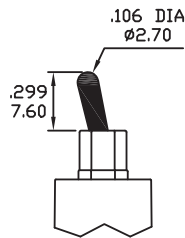

* Subtract 2.20mm (.087") from actuator height for B1 bushing

* Subtract 1.90mm (.075) from actuator height for B1 bushing

BUSHING OPTIONS

B1

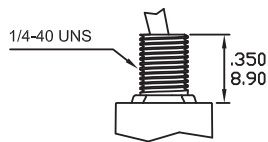

B4

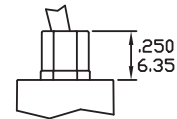

TERMINATION OPTIONS

M1 STD. SOLDER LUG

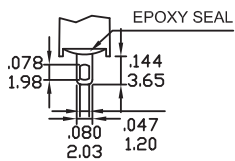

THK .030 (0.75)

M2 PC THRU-HOLE

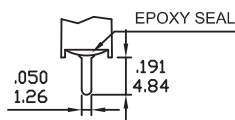

THK .030 (0.75)

M3 QUICK CONNECT

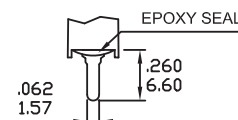

THK .030 (0.75)

M5 WIRE WRAP

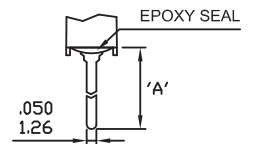

THK .030 (0.75)

OPTION CODE	DIM.'A'
M5-1	.750(19.05)
M5-2	.964(24.48)
M5-3	.425(10.80)
M5-4	1.062(26.97)

TERMINATION OPTIONS

M6

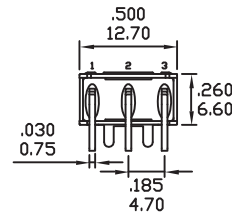
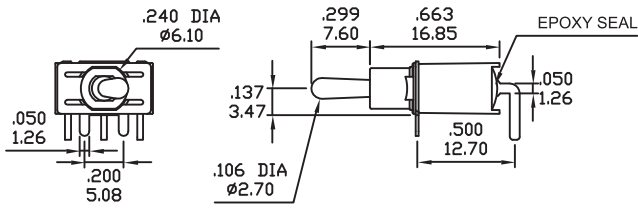

P.C.MOUNTING

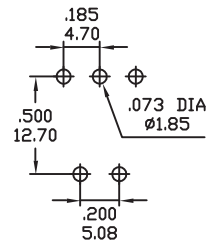

SPDT

M6

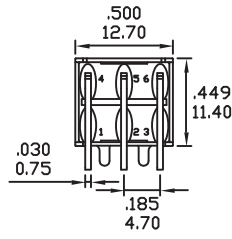
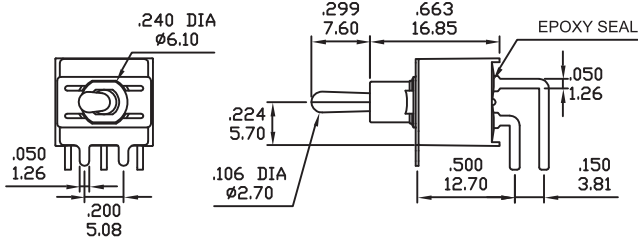
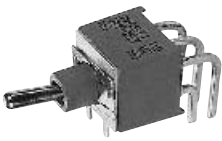

P.C.MOUNTING

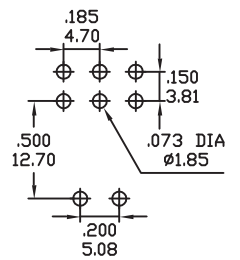

DPDT

M6

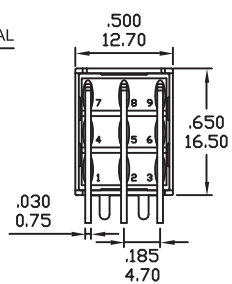
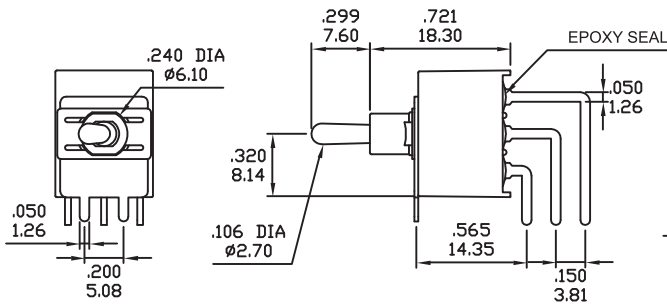
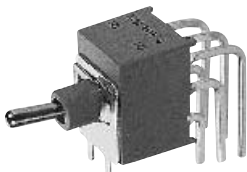

P.C.MOUNTING

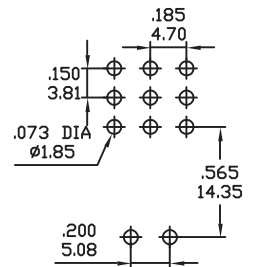

3PDT

M7

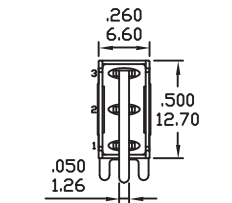
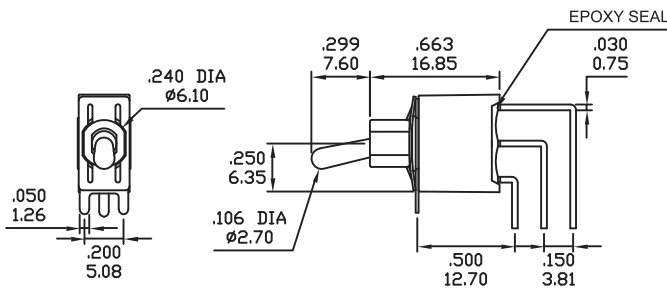
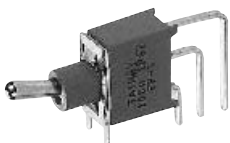

P.C.MOUNTING

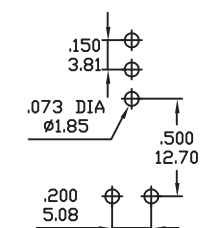

SPDT

M7

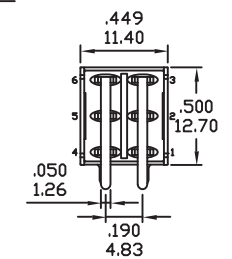
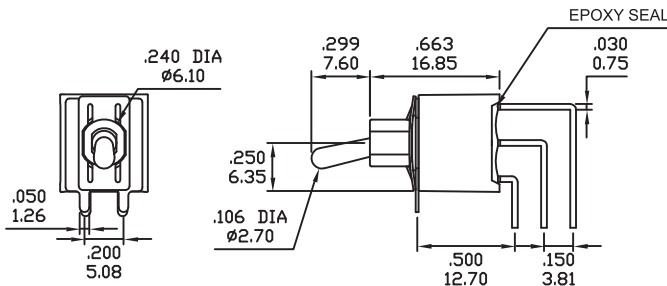
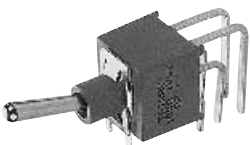

P.C.MOUNTING

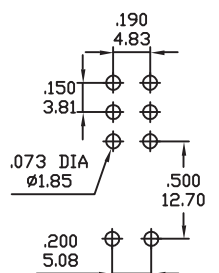

DPDT

TERMINATION OPTIONS

M7



3PDT

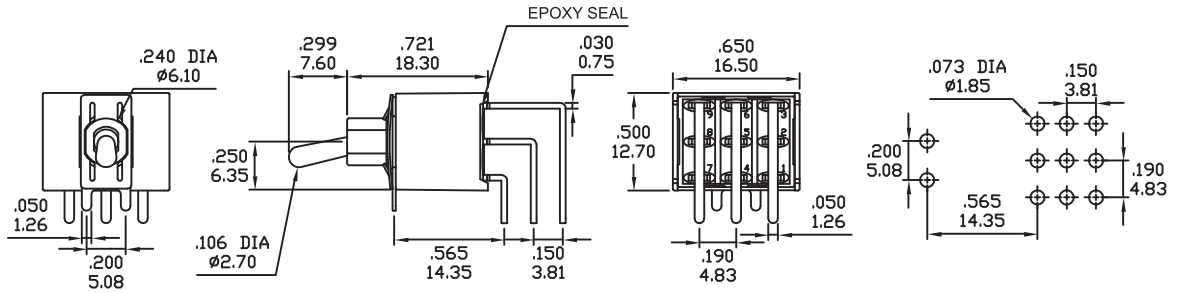

P.C.MOUNTING

VS2-VS3

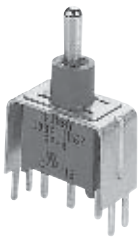

SPDT

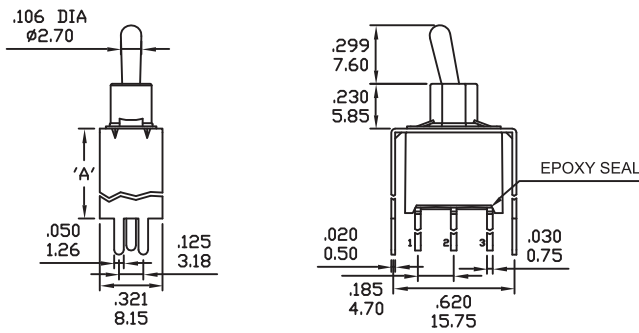

OPTION CODE	DIM.'A'
VS2	.461 11.70
VS3	.630 16.00

P.C.MOUNTING

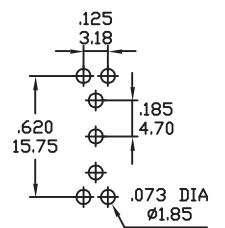

VS2-VS3

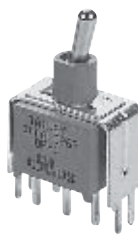

DPDT

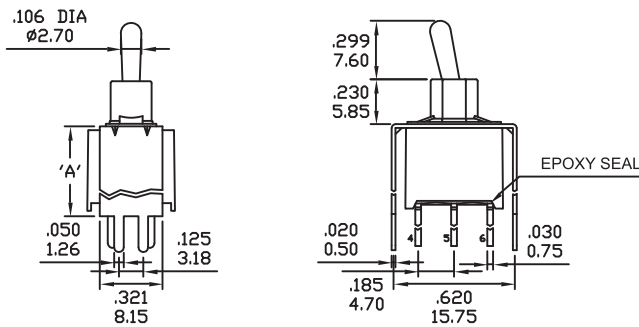

OPTION CODE	DIM.'A'
VS2	.461 11.70
VS3	.630 16.00

P.C.MOUNTING

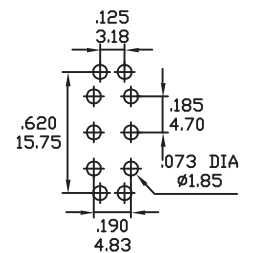

U2-VS3

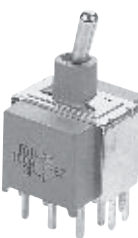

3PDT

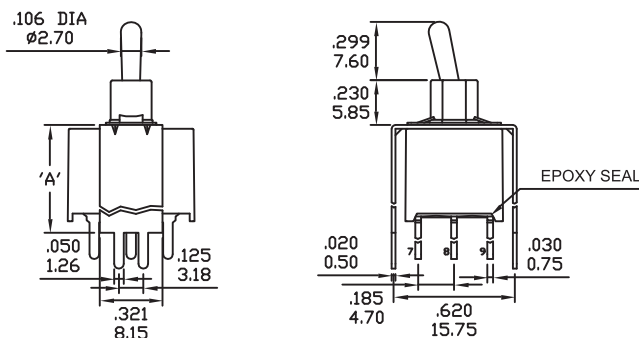

OPTION CODE	DIM.'A'
U2	.551 14.00
VS3	.630 16.00

P.C.MOUNTING

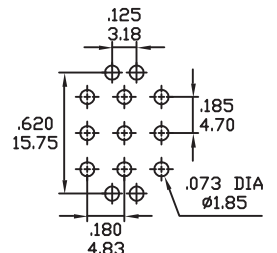

VS4-VS5

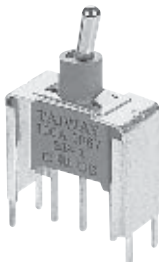

SPDT

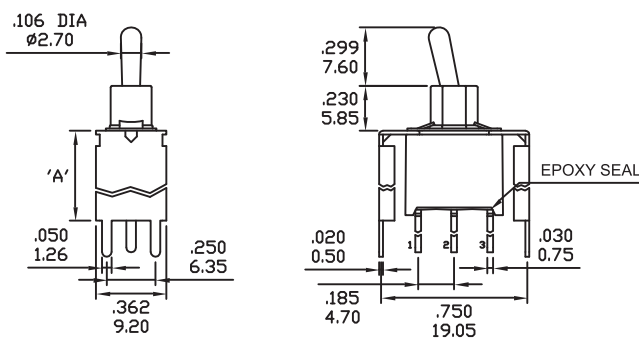

OPTION CODE	DIM.'A'
VS4	.461 11.70
VS5	.630 16.00

P.C.MOUNTING

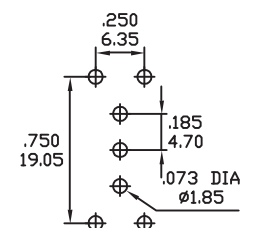

TERMINATION OPTIONS

VS4-VS5

P.C.MOUNTING

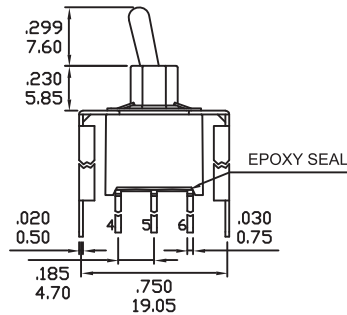
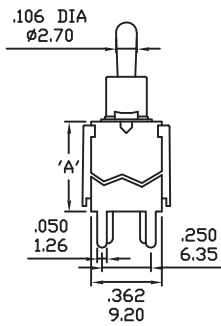
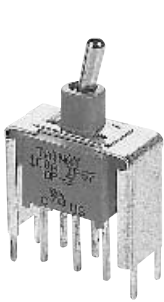

OPTION CODE	DIM.'A'
VS4	.461 11.70
VS5	.630 16.00

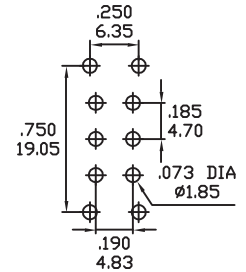

DPDT

U4-VS5

P.C.MOUNTING

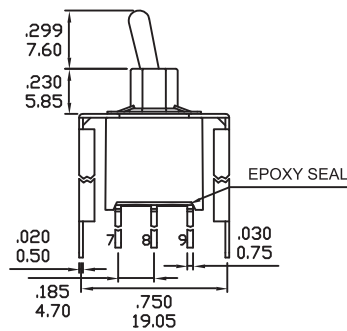
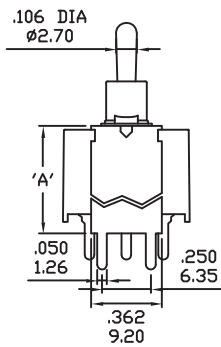
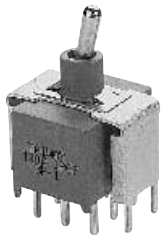

OPTION CODE	DIM.'A'
U4	.551 14.00
VS5	.630 16.00

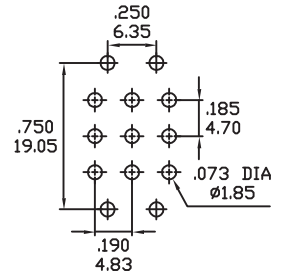

3PDT

SNAP-IN TERMINATION OPTIONS

M61

VS21,VS31

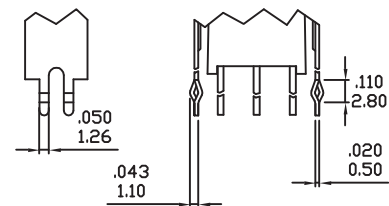
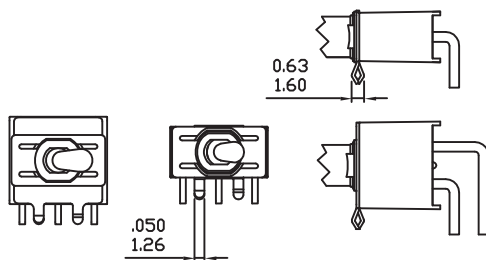

M71

VS41,VS51

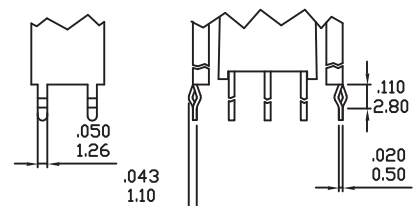
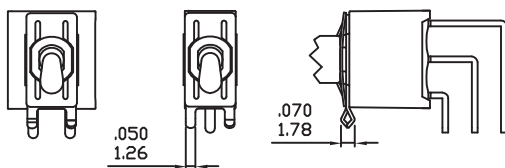

* PC Mounting for M61,M71,VS21,VS31,VS41,VS51 refer to M6,M7,VS2,VS3,VS4,VS5 respectively.

HARDWARE

NUT

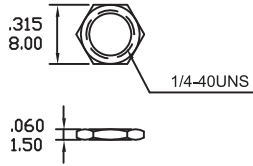

LOCKING RING

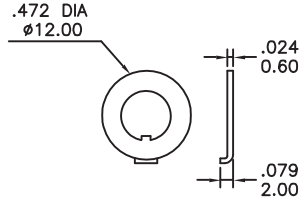

LOCK WASHER

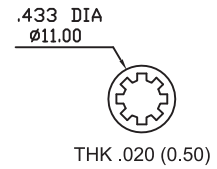

* Nut,locking ring and lock washer supplied standard with threaded bushings.
 * Consult us for optional nut, locking ring and lock washer styles.

CONTACT MATERIAL OPTIONS

Coding	Contact Material	Terminal Plating	Rating	Agency Approvals
G	Silver ¹	Gold over silver ³	5Amps @ 125VAC or 28VDC 2Amps @ 250VAC	 IP67
P		Tin plated ⁵ / ₇		
R	Gold ²	Gold plated ⁴	0.4VA max @ 20V max (AC or DC)	IP67
K		Tin plated ⁵ / ₆		

* Standard G plating for sealed product.

1. Movable Contact: Copper alloy, silver plated.
2. Movable Contact: Copper alloy with gold plated over nickel plated.
3. Terminals: Silver plated with outer layer in gold plating.
4. Terminals: Copper alloy, with gold plated over nickel plated.
5. Outer Terminals: Copper alloy with pure tin plated.
6. Terminal Contact: Gold plated over nickel plated.
7. Terminal Contact: Palladium nickel alloy (or Silver) plated.

* P, K not available with M1 and M3 terminals.

* 6Amps (Movable Contact: coin silver, silver plated) available to model ON-NONE-ON without UL approval

* IP67 protection for 100A series only.