

SPECIFICATIONS:

CONTACT RATING: DC 12V 0.5A.
CONTACT RESISTANCE: 30mΩ max.
MECHANICAL LIFE: 1,000 cycles.
INSULATION RESISTANCE: 500MΩ min. at 500VDC.

MATERIALS:

HOUSING: Nylon 6/6 (UL94V-0).
SLIDE HANDLE: Nylon 6/6 (UL94V-0).
TERMINAL: Brass, gold over nickel plated.

If your preferred product configuration is not shown, please contact our sales representative for custom design.

HOW TO ORDER SYSTEM

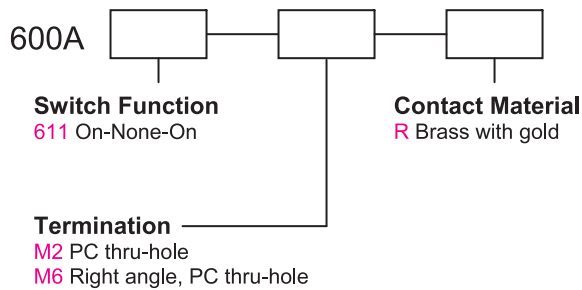

Series 600A

Low Power Slide Switches

M2



Model No.	Switching Position		
611	ON	NONE	ON
Term. Comm.	2-1	OPEN	2-3

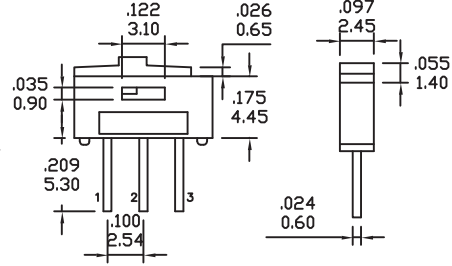
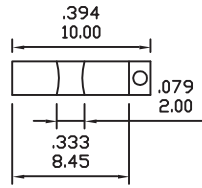

P.C.MOUNTING

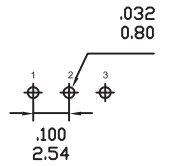

SPDT

M6



Model No.	Switching Position		
611	ON	NONE	ON
Term. Comm.	2-1	OPEN	2-3

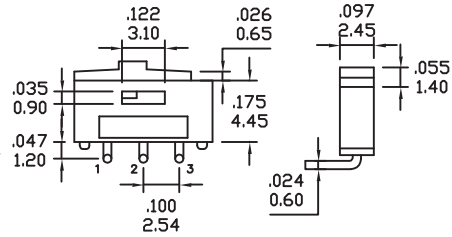
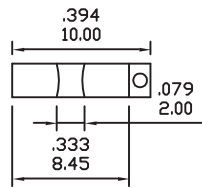

P.C.MOUNTING

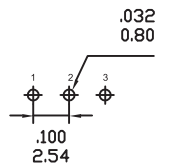

SPDT

TERMINATIONS

M2

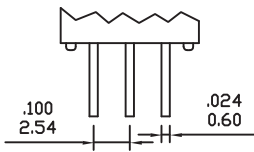

M6

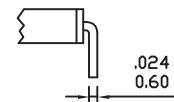

CONTACT MATERIAL OPTIONS

Coding	Contact & Terminal Material	Rating	Agency Approvals
R	Brass with gold plating	0.5A @ 12VDC	