

SPECIFICATIONS:

CONTACT RATING: Refer to "Contact Material Options" for more info.
 ELECTRICAL LIFE: 30,000 make-and-break cycles at full load.
 CONTACT RESISTANCE: 20m Ω max. initial @ 2-4 VDC
 100mA for both silver and gold plated contacts.
 INSULATION RESISTANCE: 1,000M Ω min.
 DIELECTRIC STRENGTH: 1,500 V RMS @ sea level.
 OPERATING TEMPERATURE: -30°C to + 85°C.

MATERIALS:

CASE: Diallyl phthalate(DAP)(UL 94V-0).
 ROCKER: Nylon 6/6 (UL 94V-0).
 BUSHING: Zinc, nickel plated.
 HOUSING: Stainless Steel.
 SWITCH SUPPORT: Brass, tin plated.
 TERMINAL SEAL: Epoxy.

If your preferred product configuration is not shown, please contact our sales representative for custom design.

HOW TO ORDER SYSTEM

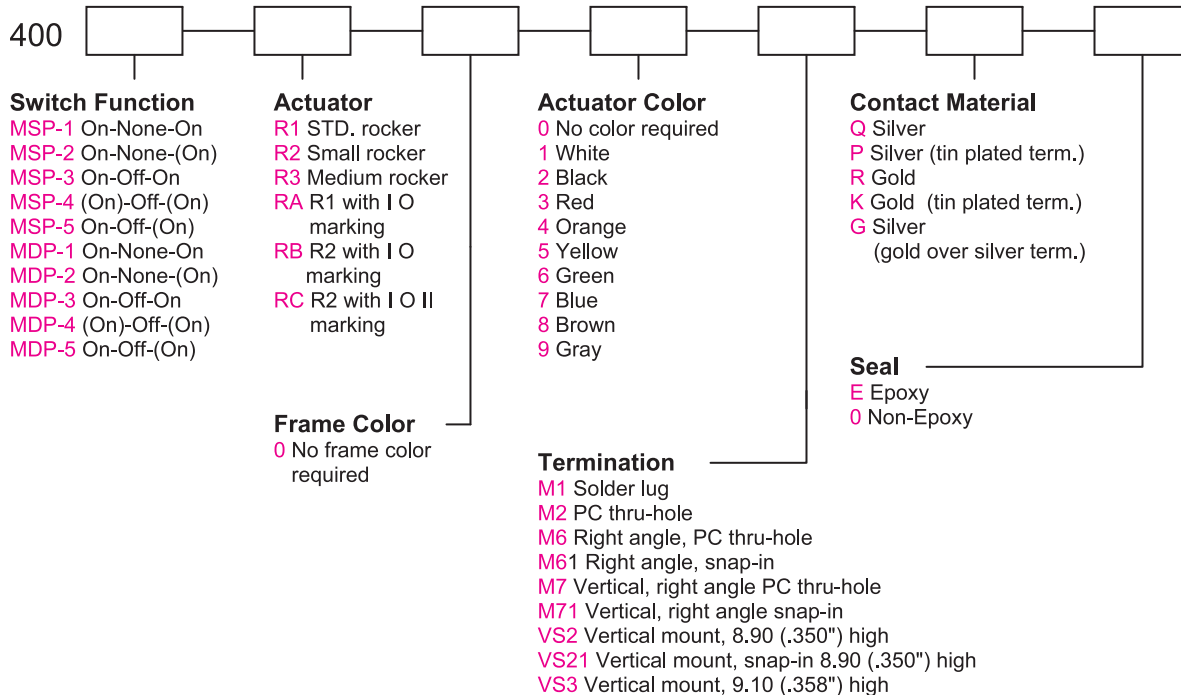

Series 400

Sub-Miniature Rocker Switches

SPDT



Model No.	Switching Position		
MSP-1	ON	NONE	ON
MSP-2	ON	NONE	(ON)
MSP-3	ON	OFF	ON
MSP-4	(ON)	OFF	(ON)
MSP-5	ON	OFF	(ON)
TERM. COMM.	2-3	OPEN	2-1

Schematic

O2Comm.

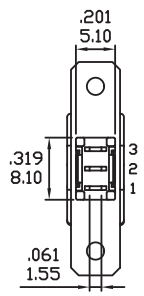
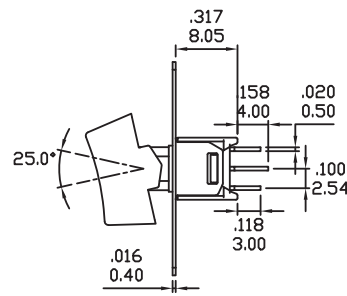
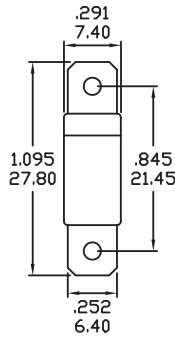

DPDT

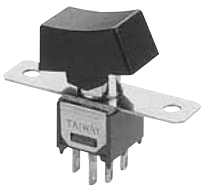

Model No.	Switching Position		
MDP-1	ON	NONE	ON
MDP-2	ON	NONE	(ON)
MDP-3	ON	OFF	ON
MDP-4	(ON)	OFF	(ON)
MDP-5	ON	OFF	(ON)
TERM. COMM.	2-3,5-6	OPEN	2-1,5-4

Schematic

O2Comm.

O5Comm.

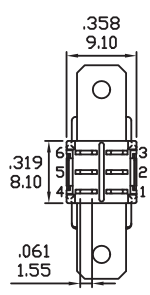
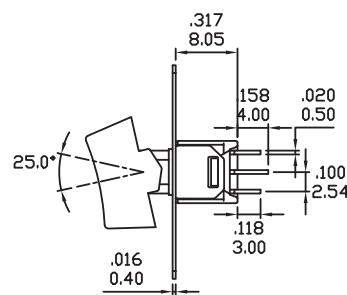
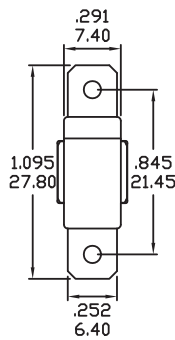

ACTUATOR OPTIONS

R1

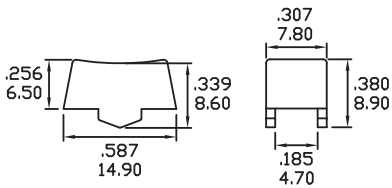

R2

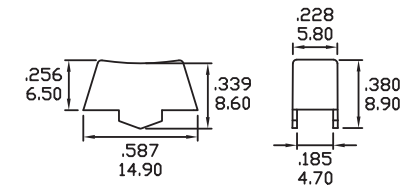

R3

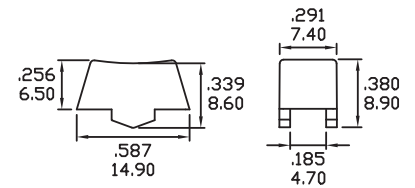

TERMINATION OPTIONS

M1 STD. SOLDER LUG

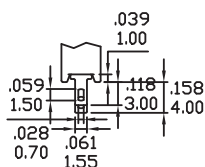

M2 PC THRU-HOLE

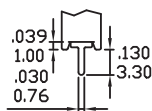

M1 STD. SOLDER LUG

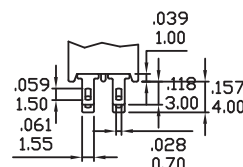

M2 PC THRU-HOLE

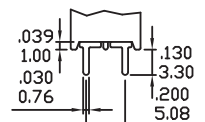

SP

DP

TERMINATION OPTIONS

M6

P.C.MOUNTING

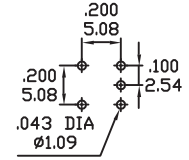
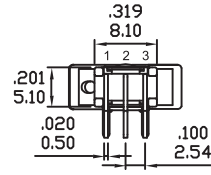
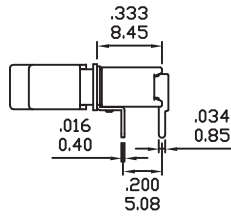
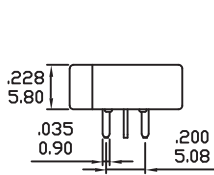

SPDT

M6

P.C.MOUNTING

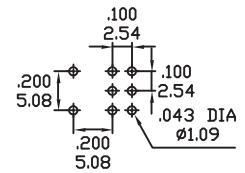
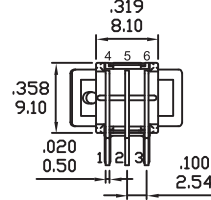
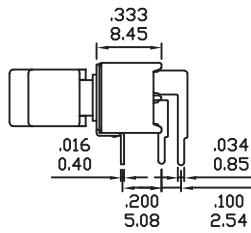
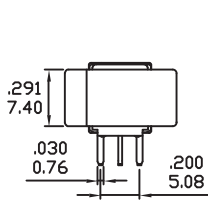
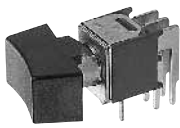

DPDT

M7

P.C.MOUNTING

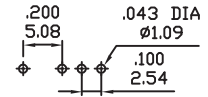
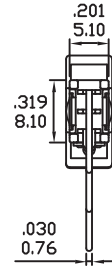
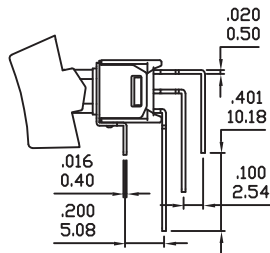
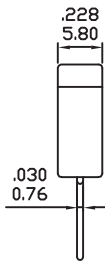
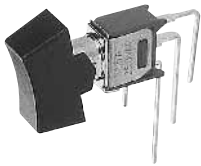

SPDT

M7

P.C.MOUNTING

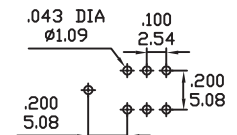
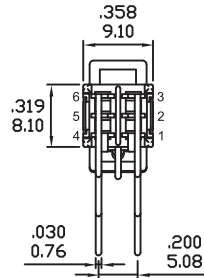
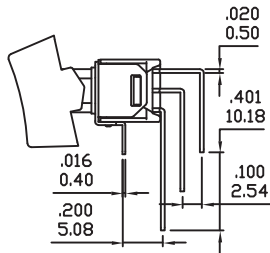
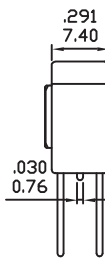
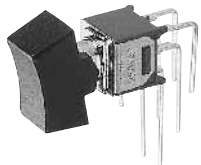

DPDT

VS2-VS3

P.C.MOUNTING

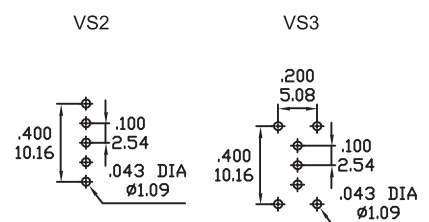
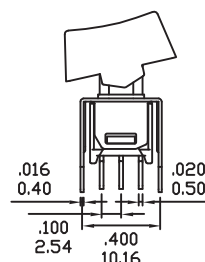
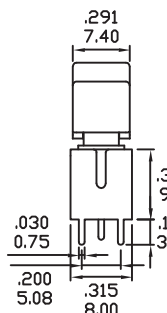
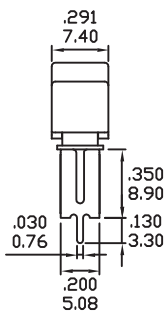

SPDT

TERMINATION OPTIONS

VS2-VS3



DPDT

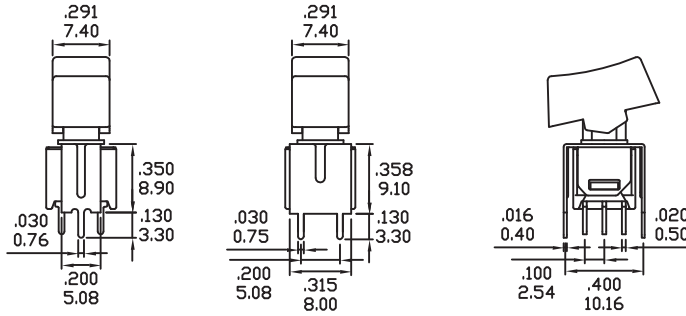

P.C.MOUNTING

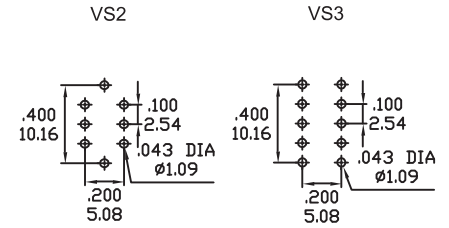

SNAP-IN TERMINATION OPTIONS

M61

M71

VS21

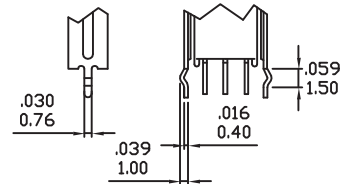
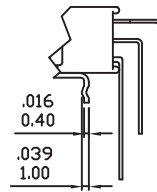
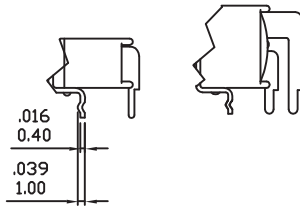

* PC Mounting for M61,M71,VS21 refer to M6,M7,VS2 respectively.

CONTACT MATERIAL OPTIONS

Coding	Contact Material	Terminal Plating	Rating	Agency Approvals
Q	Silver ¹	Silver plated ¹	3Amps @ 125VAC or 28VDC 1.5Amps @ 250VAC	
P		Tin plated ^{5,7}		
R	Gold ²	Gold plated ⁴	0.4VA max @ 20V max (AC or DC)	
K		Tin plated ^{5,6}		
G	Silver ¹	Gold over silver ³	3Amps @ 125VAC or 28VDC 1.5Amps @ 250VAC	

1. Movable Contact / Terminals: Copper alloy, silver plated.
2. Movable Contact: Copper alloy with gold plated over nickel plated.
3. Terminals: Silver plated with outer layer in gold plating.
4. Terminals: Copper alloy, with gold plated over nickel plated.
5. Outer Terminals: Copper alloy with pure tin plated.
6. Terminal Contact: Gold plated over nickel plated.
7. Terminal Contact: Palladium nickel alloy (or Silver) plated.

* P, K is not available with M1 terminal.