

SPECIFICATIONS:

RATING: DC 3V 50uA-Dc 5V 10mA.

OPERATING TEMPERATURE: -20°C to +70°C.

OPERATING FORCE: 0.3N (31gf).

RESISTANCE TO SOLDERING HEAT: Manual soldering 300°C 3sec.

Reflow soldering 250°C 20sec max.

CONTACT RESISTANCE(Initial performance/ After lifetime): 500m-ohms max. /1-ohms max.

INSULATION RESISTANCE: More than 100M-ohms at 100VDC.

WITHSTANDING VOLTAGE: 100VAC, 1 minute.

OPERATING LIFE(WITH LOAD): 100,000 cycles.

Specifications and Dimensions subject to change

12MTL

REFLOW PATTERN

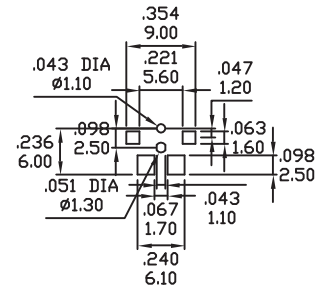
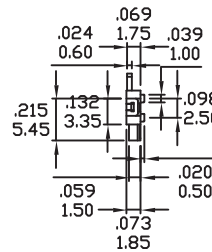
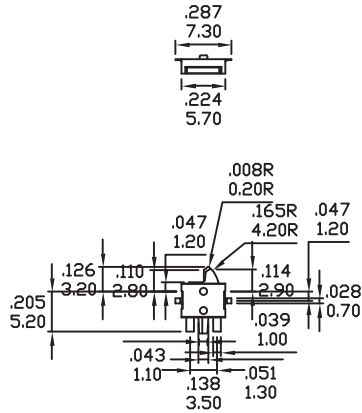
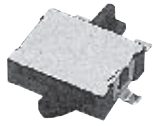

12MTR

REFLOW PATTERN

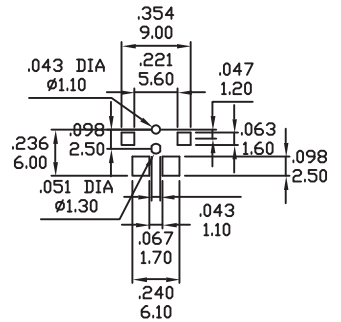
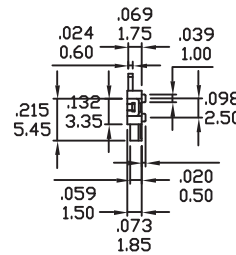
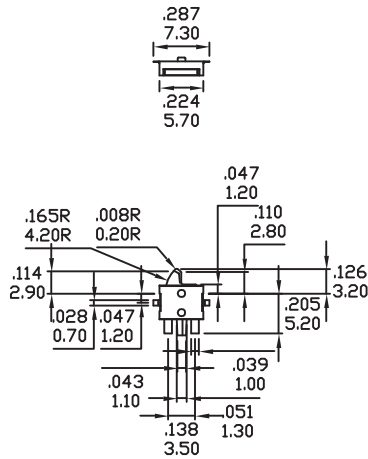
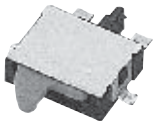

12NTL

REFLOW PATTERN

